

Ambient and Installation Conditions

- Altitude up to 2000m;
- Ambient medium temperature should be within -5°C to +40°C (+45°C for marine products);
- It can withstand the effect of damp air;
- It can withstand the effect of moulds;
- It can withstand the effect of nuclear radiation;
- The max inclination is 22.5°C.
- It still can work reliably when the ship subjects to normal vibration;
- It can still work reliably if the product subjects to the earthquake (4g).
- Places where the surrounding medium is free from explosion danger, and far away from gas or conductive dust that would erode the metal or destroy the insulation;
- Keep away from rain or snow.

Components of Circuit Breaker

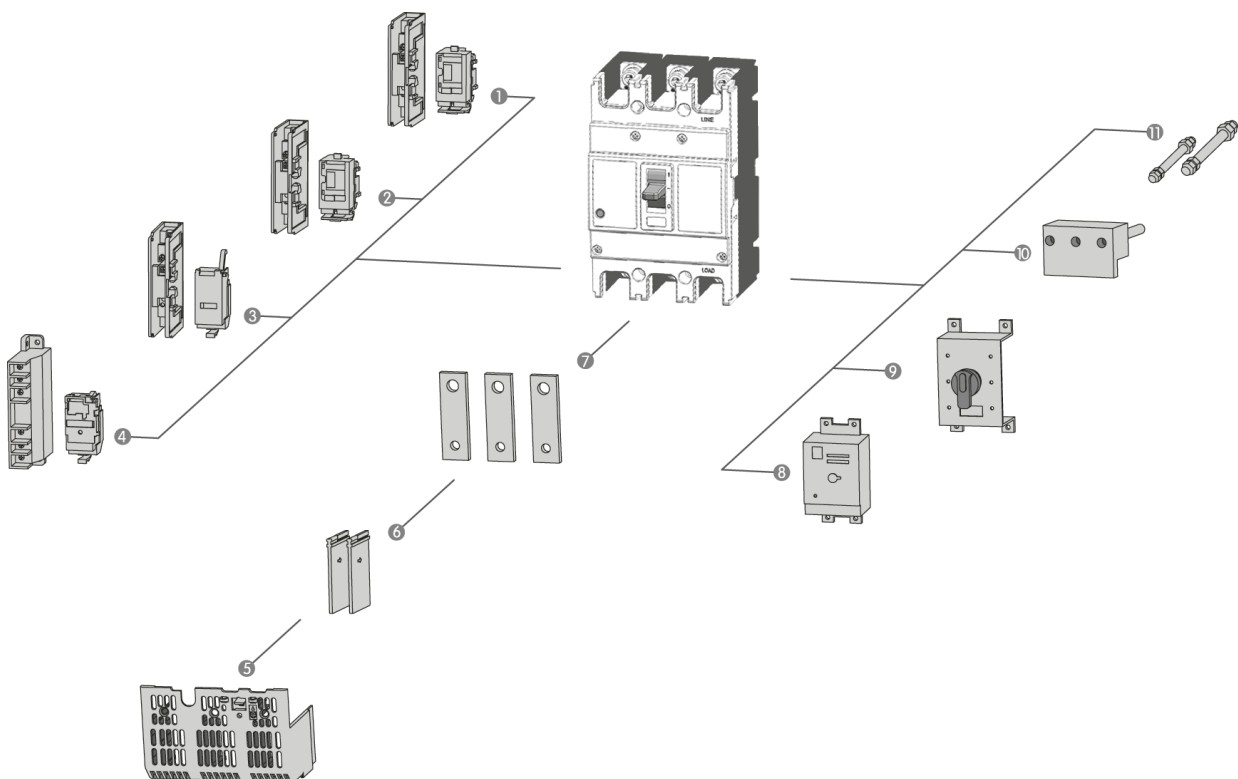

1: Auxiliary switch

2: Alarm switch

3: Shunt release

4: Undervoltage release

5: Terminal cap

6: Phase partition

7: Front-board wiring

8: Electric operation

9: Manual operation

10: Plug-in type back-board wiring

11: Back-board wiring

Product Selection Guide

QM1 - 125 / 4 300 - 125A 2 A 1 D1 2

| QM1 | 125 | C | | | | P | 4 |
|------------------------------|--|---------------|-------|-------|-------|--|------------------------|
| ↓ | ↓ | ↓ | | | | ↓ | ↓ |
| Product code | Frame size | Current class | | | | Code of control circuit source voltage | Pole number |
| | | | S | M | H | | |
| Moulded-case circuit breaker | 125 160 250 400 630 800 | 125 | 25/18 | - | 35/25 | P: electric operation Z: rotary handle W: direct operation | 3: 3-pole 4: 4-pole |
| | Note: 125 is upgraded type of 63 frame 160 is upgraded type of 100 frame 250 is upgraded type of 225 frame 630 is upgraded type of 400 frame | 160 | 25/18 | 35/25 | 50/35 | | |
| | | 250 | 25/18 | 35/25 | 50/35 | | |
| | | 400 | 35/25 | 50/35 | 65/65 | | |
| | | 630 | 35/25 | 50/35 | 65/65 | | |
| | | 800 | 35/25 | 50/35 | 65/65 | | |

| 300 | 125A | 2 | A |
|---|--|--|--|
| ↓ | ↓ | ↓ | ↓ |
| Release type and internal accessory | Rated current (A) | Application | Code of four-pole product |
| The first digit represents release type 2: Has instantaneous release only 3: Complex release Note: Later two digits are the code of accessories (see accessory table) | 125 10, 16, 20, 25, 32, 40, 50 63, 80, 100, 125 160 63, 80, 100, 125, 140, 160 250 100, 125, 140, 160 180, 200, 225, 250 400 250, 300, 315, 350, 400 630 400, 500, 630 800 500, 630, 700, 800 | 1: power distribution 2: motor protection | A: N-pole without protection cannot close or open B: N-pole without protection can close and open C: N-pole with protection can close and open D: N-pole with protection cannot close or open |



| Q1 | | | D1 | | Q | 2 |
|----------------------|---------------|-----------------|--|-----------------------------------|--|-----------------------------|
| ↓ | | | ↓ | | ↓ | ↓ |
| Accessory voltage | | | Electric operation voltage | | Installation methods | Install wiring board or not |
| Undervoltage release | Shunt release | Auxiliary alarm | DC1 Electric Operation | DC3 Electric Operation | Q: Front-board H: Back-board C: Plug-in type | 1: No 2: Yes |
| Q1: AC220V | F1: AC220V | J1: AC125V | D1: AC220V | D5: AC230V | | |
| Q2: AC240V | F2: AC380V | J2: AC250V | D2: AC230V | D6: AC110V | | |
| Q3: AC380V | F3: DC110V | J3: DC125V | D3: AC380V | D7: DC220 | | |
| Q4: AC415V | F4: DC24V | J4: DC24V | D4: AC400V | D8: DC110 | | |
| | | | | D9: AC110-240V D10: DC100-220V | | |
| | | | Note: Adaptable voltages for two electric operations. Please refer to the introduction of external accessory. | | | |

Moulded Case Circuit Breaker Series QM1

Quality & Service creates value



Main Performance Indexes

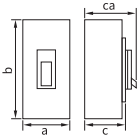

| Frame current A () | | 125 | | 160 | | | |
|--|--|---|---------------|---|---------------|---------------|----------------|
| Model | | QM1-125S | QM1-125H | QM1-160S | QM1-160M | QM1-160H | |
| Pole number | | 1, 2, 3, 4 | | 2, 3, 4 | | | |
| | |  | |  | | | |
| Rated current (A) | | 10, 16, 20, 32, 25, 40, 50, 63, 80, 100, 125 | | 63, 80, 100, 125, 140, 160 | | | |
| Rated voltage (V) | | AC400V | | AC400V | | | |
| Rated insulation voltage (V) | | AC1000V | | AC1000V | | | |
| Short-circuit breaking capacity(KA) Icu/Ics | | AC400V | 25/18 | 35/25 | 25/18 | 35/25 | 50/35 |
| Operating cycle number | | Electrical life | | 6000 | | 3000 | |
| | | Mechanical life | | 9000 | | 7000 | |
| Outline dim(mm) a-b-c-ca  | | 1P | 25-130-68-90 | | - | - | - |
| | | 2P | 50-130-68-90 | | 60-155-68-90 | 60-155-68-90 | 60-155-88-115 |
| | | 3P | 75-130-68-90 | | 90-155-68-90 | 90-155-68-90 | 90-155-88-115 |
| | | 4P | 100-130-68-90 | | 120-155-68-90 | 120-155-68-90 | 120-155-88-115 |
| Weight (kg) | | 1P | 0.32 | - | - | - | |
| | | 2P | 0.5 | 0.55 | 1.0 | 1.1 | |
| | | 3P | 0.55 | 0.65 | 1.1 | 1.2 | |
| | | 4P | 0.65 | 0.8 | 1.4 | 1.5 | |
| Electric operating device (MD) | | ● | | | | | |
| External driving operating handle | | ● | | | | | |
| Automatic release | | Thermal electromagnetic type | | | | | |

Moulded Case Circuit Breaker Series QM1

Quality & Service creates value



Main Performance Indexes

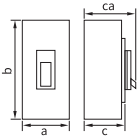

| Frame current A () | | 250 | | | 400 | | | |
|---|--|---|---------------|----------|---|----------|-----------------|-------|
| Model | | QM1-250S | QM1-250M | QM1-250H | QM1-400S | QM1-400M | QM1-400H | |
| Pole number | | 3, 4 | | | 3, 4 | | | |
| | |  | | |  | | | |
| Rated current (A) | | 100, 125, 140, 160, 180, 200, 225, 250 | | | 250, 315, 350, 400 | | | |
| Rated voltage (V) | | AC400V | | | AC400V | | | |
| Rated insulation voltage (V) | | AC1000V | | | AC1000V | | | |
| Short-circuit breaking capacity(KA) Icu/Ics | | AC400V | 25/18 | 35/25 | 50/35 | 35/25 | 50/35 | 65/65 |
| Operating cycle number | | Electrical life | | 3000 | | 2000 | | |
| | | Mechanical life | | 7000 | | 4000 | | |
| Outline dim(mm) a-b-c-ca | | | | | | | | |
|  | | 3P | 105-165-68-92 | | 105-165-88-115 | | 140-257-103-155 | |
| | | 4P | 140-165-68-92 | | 140-165-88-115 | | 184-257-103-155 | |
| Weight (kg) | | 3P | 1.5 | | 1.7 | | 5.5 | |
| | | 4P | 1.9 | | 2.1 | | 7.0 | |
| Electric operating device (MD) | | ● | | | | | | |
| External driving operating handle | | ● | | | | | | |
| Automatic release | | Thermal electromagnetic type | | | | | | |

Moulded Case Circuit Breaker Series QM1

Quality & Service creates value

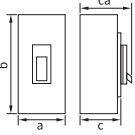

Main Performance Indexes

| Frame current A () | | 630 | | | 800 | | | |
|---|--|---|-----------------|----------|---|-----------------|----------|-------|
| Model | | QM1-630S | QM1-630M | QM1-630H | QM1-800S | QM1-800M | QM1-800H | |
| Pole number | | 3, 4 | | | 3, 4 | | | |
| | |  | | |  | | | |
| Rated current (A) | | 250, 315, 350, 400, 500, 630 | | | 500, 630, 700, 800, 1250 | | | |
| Rated voltage (V) | | AC400V | | | AC400V | | | |
| Rated insulation voltage (V) | | AC1000V | | | AC1000V | | | |
| Short-circuit breaking capacity(KA) Icu/Ics | | AC400V | 35/25 | 50/35 | 65/65 | 35/25 | 50/35 | 65/65 |
| Operating cycle number | | Electrical life | 2000 | | | 1500 | | |
| | | Mechanical life | 4000 | | | 4000 | | |
| Outline dim(mm) a-b-c-ca | | | | | | | | |
|  | | 3P | 140-257-103-155 | | | 210-275-103-155 | | |
| | | 4P | 184-257-103-155 | | | 280-275-103-155 | | |
| Weight (kg) | | 3P | 5.7 | | | 9.5 | | |
| | | 4P | 7.5 | | | 12.5 | | |
| Electric operating device (MD) | | | | | ● | | | |
| External driving operating handle | | | | | ● | | | |
| Automatic release | | Thermal electromagnetic type | | | | | | |